CONTENTS

Your dishwasher

Introduction	4
--------------	---

Description

Control panel	5
Interior	5

First use

Setting the water softener	6
Adding salt	7

Operation

Switching on	8
Cycle selection table	10

use

Rinse aid	11
Dishwasher detergents	12
Loading the baskets	14
Damage to glassware and other crockery	16

Maintenance

Cleaning the filter section	17
Cleaning the spray arms	18
Cleaning the door	18

Errors

What should I do, if...	19
Error table	19
Error codes	21

Technical data sheet

Built-in dimensions	22
Technical data sheet	22

Loading the baskets according to EN50242

24

Your dishwasher and the environment

Disposal	26
----------	----

Introduction

You have opted to purchase a Etna dishwasher.

Optimum user comfort and easy operation were paramount during the development of this product.

This manual describes how you can get the most out of your dishwasher. It provides you with information on how to operate the appliance, as well as background information about how it works. You will furthermore also find maintenance tips.

The safety instructions that are relevant during the installation are included in the installation guide. This is intended for the installation technician.

Read this manual before using the appliance. Keep this manual somewhere safe so that subsequent users can also benefit from the information contained within.

Before use, read the separate safety instructions first!

DESCRIPTION

Control panel

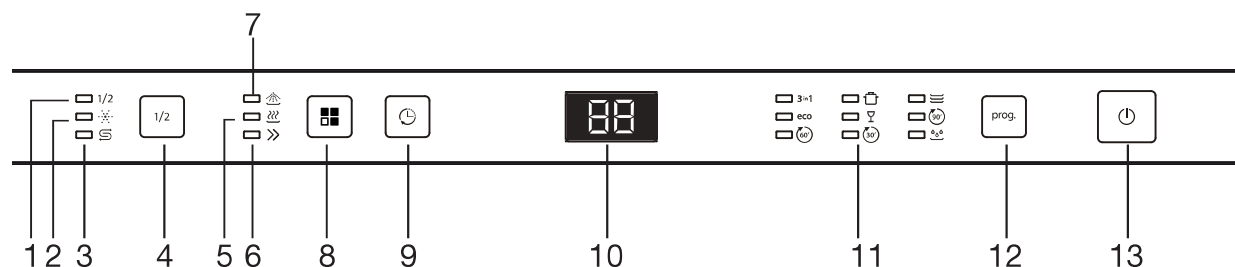

1. 'Half load' indicator
2. Rinse agent indicator
3. Water softener indicator
4. 'Half load' button
5. Extra drying indicator
6. Express wash indicator
7. Extra washing indicator
8. Function button (for selecting Extra drying, Express wash and Extra washing)
9. Delay button
10. Display
11. Program indicator
12. Program button
13. On/Off button

Interior

14. Cup shelf
15. Upper basket
16. Lower basket
17. Salt container
18. Detergent and rinse agent reservoir
19. Cup shelf
20. Spray arms
21. Filter assembly

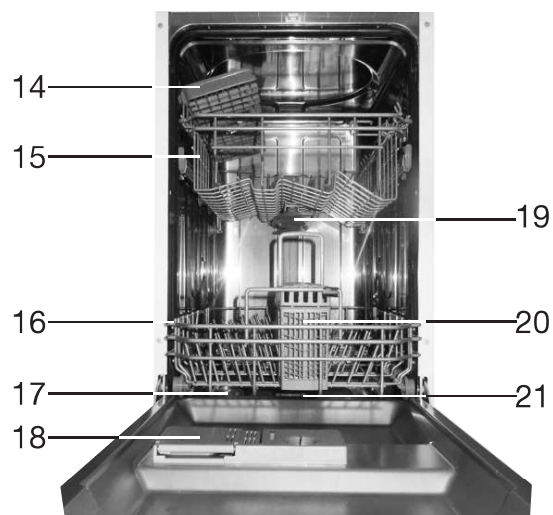

FIRST USE

Before using the dishwasher for the first time:

- Set the water hardness.
- Add 1 litre of water to the salt reservoir and then add 1.5 kg of dishwasher salt.
- Add rinse agent.
- Add detergent.

Setting the water softener

1. Open the door.
2. Press the “on/off” button to switch on the appliance.
3. Press the Program button for more than 5 seconds to start the water softener set model within 60 seconds after the appliance was switched on (the water softener and Rinse agent warning lights will be on periodically when it get in the set model).
4. Press the Program button to select the proper set according to your local environment, the sets will change in the following sequence: H1->H2->H3->H4->H5->H6 / see water softener table.
5. Press the “on/off” button to end the setup mode.

Water softener table

Water hardness				
°Clarke	°dH	mmol/l	setting in display	Salt consumption (grams/cycle)
0 - 6	0 - 5	0 - 0,94	H1	0
7 - 14	6 - 11	1,0 - 2,0	H2	9
15 - 21	12 - 17	2,1 - 3,0	H3	12
22 - 28	18 - 22	3,1 - 4,0	H4	20
29 - 42	23 - 34	4,1 - 6,0	H5	30
43 - 69	35 - 55	6,1 - 9,8	H6	60

The manufactory setting: H3 (EN 50242)

Contact your local water authority for information on the water hardness of your water supply.

FIRST USE

Adding salt

This machine is equipped with a water softener. To use the water softener, fill the dishwasher with salt.

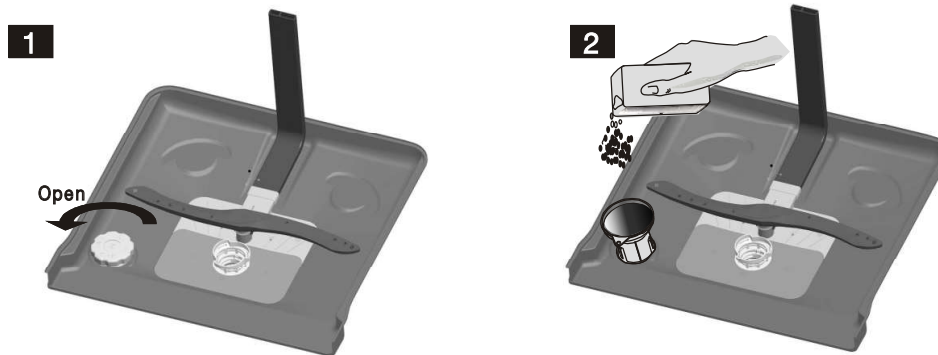

1. Remove the bottom basket and then unscrew the cap from the reservoir.
2. Before filling the reservoir for the first time, pour in one litre of water.
3. Insert the funnel into the reservoir opening. Pour in approximately 1 kg of salt. It is normal for a little water to flow out of the opening when doing this. **Note!** Clear up any spilled salt and always run a full cycle immediately afterwards to prevent damage to the bottom.
4. Screw the cap back on firmly.



Note! Always fill the salt reservoir and adjust the water hardness setting before using the dishwasher. Refill the salt reservoir when the water softener indicator lights up. It is possible that the light will remain lit for a short while after the salt reservoir is filled. It will go out automatically when enough salt has been dissolved in the water.

Switching on

1. Open the door.
2. Load the dishes in the upper and lower basket.
3. Add detergent and rinse agent (consult 'Dishwasher detergents' and 'Rinse aid'). Check the amount of salt in the salt reservoir (consult 'Adding Salt').
4. Press the “on/off” button to switch on the appliance.
The indicator will light up when the appliance is switched on.
5. Select the desired cycle (see “cycle selection table”).
Press the program button repeatedly to select the required cycle.
The corresponding indicator of the selected cycle will light up.
6. Close the door.
The dishwasher will automatically start running the selected cycle.

Delayed start time

- If you want the dishwasher to switch on at a later time, you can use the “delayed start” button. You can choose to delay the start time by 1 to 24 hours. Set the desired delay time with the “delayed start” button. The display shows the delayed start time that has been selected.

Stopping or changing a wash cycle

- Open the door.
- Press and hold the programming button for more than 3 seconds.
You can now re-select the desired cycle (see “cycle selection table”).
Close the door.



Note! A cycle that has already begun can only be changed in the start-up phase. After this, the detergent will be sprayed all over the dishes or the machine may have already pumped out the water. In that instance, you must refill the detergent compartment (see section on Detergent compartment).

Following the end of the wash cycle

Once the wash cycle has completed, an audible signal will sound for eight seconds.

1. Open the door.
2. Switch the appliance off using the on/off button.
Wait a few minutes before unloading the dishwasher. The dishes and cutlery will still be very hot immediately following the end of the cycle. There is a chance that dishes may break as a result of the heat. Moreover, the dishes dry better when allowed to stand for a few minutes.

OPERATION

Flood protection switch

- The safety closes the inlet valve. If water remains in the dishwasher, switch the machine off and twist to shut the inlet cock. Switch on the machine and start any program. If the water is not pumped out at the start of the program, call the service department and remove the excess water.

Select half load

- The dishwasher with Half Load Washing Function adapt to your needs, so you can save energy consumption, water consumption as well as cycle duration by loading dishes of half capacity anywhere you prefer.

Extra drying function

- Select this function for extra drying of the dishes. Only available in 'All in one', intensive, normal, ECO, glass, 90 minutes and 1 hour programs.

Extra Wash function

- Select this function to improve the cleaning efficiency. Only available in 'All in one', intensive, normal, ECO, glass, 90 minutes and 1 hour programs.

Express Wash function







- Select this function to accelerate the program. Only available in 'All in one', intensive, normal, ECO, glass, 90 minutes and 1 hour programs.



Warning! Opening the door fully during the wash cycle is dangerous. You may be splashed with hot water from the machine.

OPERATION

Cycle selection table

Program	Cycle selection information	Description of cycle	Detergent pre/main	Time (min.)	Energy (KWh)	Water (L)
3-in-1 3in1	For normally soiled (not dried on) crockery. Use a '3-in-1' tablet.	Auto wash (50 °C) Rinse Rinse (65 °C) Dry	27 gr.	210 155* 220**	0,92	10
Intensive 	Heavily soiled dishes, such as dishes pans, casseroles, plates plates with dried-on leftover food.	Prewash (50 °C) Main wash (60 °C) Rinse Rinse Rinse (70 °C) Dry	5/22 gr.	165 140* 180**	1,4	16,5
Normal 	Normally soiled dishes, such as dishes, plates, glasses, lightly soiled pans.	Prewash (45 °C) Main wash (55 °C) Spoelen Spoelen (65 °C) Dry	5/22 gr.	175 130* 190**	1,1	13
ECO* eco	This is standard programme, it is suitable to clean normally soiled tableware and it is the most efficient programme in terms of its combined energy and water consumption for that type of tableware.	Prewash Main wash (45 °C) Rinse (65 °C) Dry	5/22 gr.	190 170* 220**	0,69	9
Glass 	Lightly soiled dishes, such as glasses, crystal and fragile porcelain.	Prewash Main wash (40 °C) Rinse Rinse (60 °C) Dry	5/22 gr.	125 110* 140**	0,75	13,5
90 minutes 	Daily dishes in 90 minutes. For day-to-day dishes, such as lightly soiled or normal plates and pans.	Main wash (65 °C) Rinse Rinse (65 °C) Dry	27 gr.	90 70* 105*	1,15	11,5
1 hour 	For lightly soiled loads that do not need excellent drying efficiency.	Prewash (50 °C) Main wash (60 °C) Rinse (60 °C) Dry	5/22gr.	60 55* 75**	0,9	9
Quick 	Lightly soiled dishes, such as glasses, crystal and fragile porcelain. No drying.	Main wash (45 °C) Rinse (50 °C) Rinse (55 °C)	20 gr.	30	0,7	10
Soak 	To rinse dishes that you plan to wash later that day	Prewash		15	0,02	3,5

* With Express function

**With Extra function

*EN 50242: This is a test cycle. The information for a comparison test in accordance with EN 50242 is as follows:

- Capacity: 9 place settings
- Position of upper basket: wheels on runners
- Wash setting: 6
- Pl: 0,49w; Po: 0,45w

Rinse aid

Rinse agent is added during the final rinse. Rinse agent prevents traces of water droplets being left behind on the clean dishes. Moreover, it ensures that the dishes dry quicker, since the water drains off more easily.

The dishwasher is designed for use with liquid rinse agent. The rinse agent reservoir is located on the inside of the door, alongside the detergent compartment.



Note: refill the rinse agent reservoir when the rinse aid indicator lights up. The reservoir has a capacity of approximately 100 ml. Do not overfill the rinse agent reservoir. This will cause the rinse agent reservoir to overflow. Rinse agent spillages must be cleaned up, otherwise they may lead to leakages as a result of extreme foaming.

1. Unscrew the cap from the rinse agent reservoir (to the left, toward the arrow with “open”).
2. Pour the rinse agent into the reservoir, taking care not to overfill it. The reservoir has a capacity of approximately 100 ml.
3. Replace the cap. Make sure that the cap is lined up with the “open” arrow and turn in the direction of the “closed” arrow.

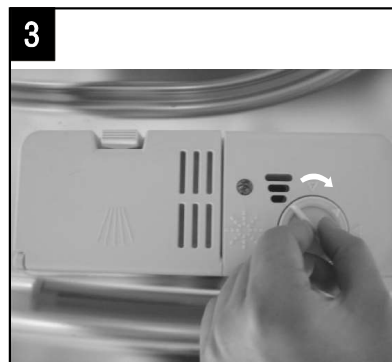

Setting the quantity of rinse agent

A fixed amount of rinse agent is added during the final rinse. As is the case with detergent, the amount of rinse agent needed is dependent on the hardness of the water in your area. Too much rinse agent can lead to streaks on the dishes.

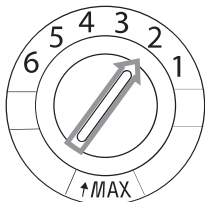

The rinse agent reservoir has 6 settings. To begin with, set the reservoir to setting 2. If this still causes spotting on the dishes and the dishes do not dry well, you can increase the amount of rinse agent added by turning the selector knob on the reservoir to setting 3. If there is still no improvement, turn the selector knob to a higher setting. Repeat this action until the dishes are streak-free when they emerge from the dishwasher.

Dishwasher detergents

The chemical agents in dishwasher detergents remove the dirt, break it down and ensure that it is drained out of the dishwasher. The dishwasher detergents you can buy in most shops are suitable for this purpose.



Warning!

Dishwasher detergent is a corrosive product. It should therefore be kept out of the reach of children. If swallowed, consult a doctor immediately and take the packaging with you.

Concentrated detergent

Based on their chemical composition, 2 different types of concentrated detergent can be distinguished:

- Conventional alkaline detergents with corrosive ingredients.
- Low-alkaline concentrated detergents with natural enzymes.

Using concentrated detergent in combination with “normal” wash cycles produces less pollution and is good for your dishes: these wash cycles are specially tailored to the dirt-dissolving properties of the enzymes contained in concentrated detergent. This means that “normal” wash cycles with concentrated detergent achieve the same results as an intensive wash cycle.

Dishwasher tablets

Dishwasher tablets from different manufacturers dissolve at different rates. This means that, during short wash cycles, certain types of dishwasher tablet do not fully dissolve, as a result of which their cleaning action is reduced. Dishwasher tablets should therefore chiefly be used in combination with long wash cycles (All-in-1), so that the dish washer tablet has time to fully dissolve.

Detergent compartment

Fill the detergent compartment prior to starting a wash cycle. Your dishwasher uses less detergent and rinse agent than conventional dishwashers. Generally speaking, just one measuring spoon of detergent powder is needed for a normal wash cycle.

Use more detergent if your dishes are more heavily soiled. Fill the soap compartment immediately prior to starting the cycle. Filling it prior to this may result in the detergent becoming damp and therefore not fully dissolving.



The 'Cycle selection table' shows the amount of detergent required for the different cycles. These are averages. A different dosage may be necessary, depending on the hardness of the water and how soiled the dishes are.

Filling

1. Press the release catch if the lid is closed. The lid will spring open.
2. Fill the detergent compartment immediately prior to starting a wash cycle.
Use only branded detergent in the dishwasher.
3. Close the lid and press until it locks in place.

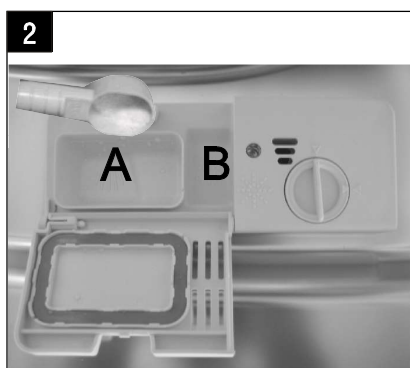
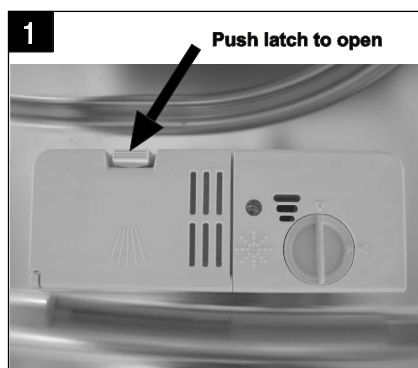

- Compartment for main wash cycle detergent (A);
- Compartment for prewash detergent (B).



Use only detergents that are specifically designed for dishwashers. Store the detergent in a cool and dry place. Only fill the detergent compartment with detergent when you are running a wash cycle immediately afterwards.

Loading the baskets

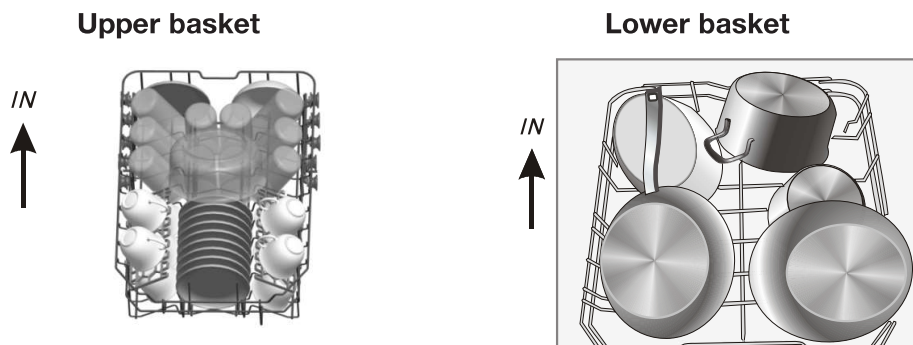

Using the upper basket

- The upper basket is designed for fragile, light dishes, such as glasses, cups and saucers, plates, small bowls and shallow (not particularly dirty) pans.
- Place the dishes in the basket in such a way as to ensure they cannot move when sprayed.

Adjusting the height of the upper basket

The height of the upper basket can be adjusted by removing the basket and replacing it in a different position in the runners.

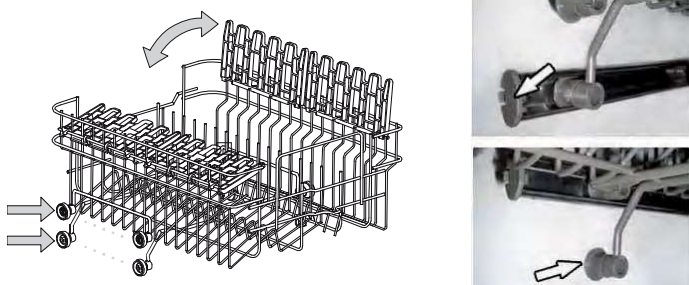

Using the lower basket

We recommend that you place large objects that are the most difficult to clean in the lower basket: pots, pans, pan lids, casserole dishes and basins.

Casserole dishes and pan lids should preferably be placed at the side of the basket. This will ensure that they do not obstruct the spray arm when it is turning.

- Saucepans, serving dishes etc. must always be placed upside down in the basket.
- Deep bowls should be tilted, with the opening facing downwards to allow water to escape.
- The lower basket can be adjusted to allow for larger, or more, pots and pans.



You can fold down the plate racks to make it easier to fit pots and pans in the dishwasher.

Cutlery basket

Cutlery should be placed in the cutlery basket with the handles pointing down. If the cutlery basket is equipped with compartments, the cutlery must be placed in the compartments piece by piece. Long cooking utensils, such as wooden spoons, should be placed lying down (horizontal) in the front of the upper basket.



Warning!

Take care to ensure that no objects are sticking through the bottom of the cutlery basket, as this will obstruct the spray arm.

Cutlery/crockery unsuitable for the dishwasher:

- Cutlery with a wooden, porcelain or mother of pearl handle
- Plastic objects that are not heat-resistant
- Cutlery with glued elements that are not heat-resistant
- Glued cutlery or crockery
- Pewter or copper objects
- Lead crystal glassware
- Steel objects that are prone to rust
- Wooden dishes
- Objects manufactured from synthetic fibres

Cutlery/crockery with limited suitability for use in the dishwasher:

- Certain types of glass can become dull after undergoing a large number of wash cycles
- Silver and aluminium may tarnish after use in the dishwasher
- Glazed patterns may fade as a result of regular washing



Note! Do not place any objects soiled with cigarette ash, candle wax, varnish or paint in the dishwasher. When buying new kitchen utensils, ensure that they are suitable for the dishwasher. Do not place any utensils that are not suitable for cleaning in the dishwasher.

Do not overload the dishwasher. There is only room for 9 standard settings. This is essential to ensure good washing results and a low energy consumption.

Placing cutlery and crockery in the dishwasher

- Before placing the dishes in the dishwasher, you must:
 - Remove any large bits of leftover food.
 - Leave caked and burnt on leftover food to soak for a while.

When inserting the dishes, take care to ensure that:

- The spray arm is not obstructed by the dishes.
- Hollow objects are placed with the opening facing downwards, to ensure that that cannot hold the water.
- Plates and cutlery must not cover each other.
- Glassware items must not touch, otherwise damage can occur.
- Place large objects that are difficult to clean in the lower basket.
- The upper basket is specially designed for lighter objects, such as glasses and coffee and tea cups.

Warning!

- Long knives standing upright in the cutlery basket can cause injury!
- Long and/or sharp items of cutlery, such as carving knives, should be laid (placed horizontally) in the upper basket.

Damage to glassware and other crockery

Potential causes:

- Type of glass or manufacturing process. Chemical composition of the dishwasher detergent.
- Water temperature and duration of the wash cycle.

Proposed solution:

- Use glassware and porcelain crockery produced by manufacturers that state that it is suitable for dishwashers.
- Use a milder/less corrosive dishwasher detergent. If needed, ask detergent manufacturers for more information.
- Select a wash cycle with a lower temperature.
- Remove glassware and cutlery from the dishwasher as soon as possible after the cycle has finished, to prevent damage.

Cleaning the filter section

Depending on usage, the filters may require regular rinsing under a tap. The filter system consists of three components: the large filter, the coarse filter and the fine filter.

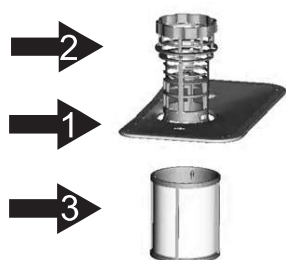

- 1. Large filter:** Leftover food and waste that lands on this filter is rinsed through to the coarse filter by a special jet on the lower spray arm.
- 2. Coarse filter:** Larger articles, such as leftover bones or pieces of glass that could block the drain, are trapped in the coarse filter. In order to remove the waste from the filter, you must lightly squeeze the lips on top of the filter together and then pull the filter upwards.
- 3. Fine filter:** This filter prevents waste and leftover food from entering the drainage pump and ensures that said leftovers are not spread over the dishes again during the cycle.

In order to ensure the dishwasher operates at maximum efficiency, the whole filter section must be cleaned. The filter section efficiently removes food remnants from the water and ensures that the water is able to continue circulating throughout the wash cycle. It is therefore a good idea to remove larger food remnants from the filter section after each wash cycle, by cleaning the half-round filter and filter housing under running water.

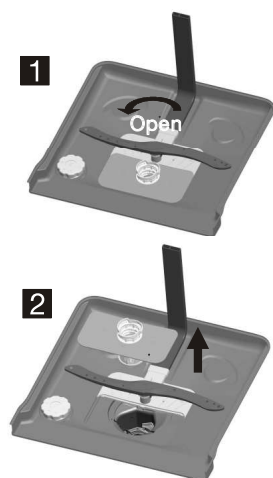

- Remove the filter section by turning in anti-clockwise direction and pulling upwards. All components in the filter section must be cleaned at least once per month. All components in the filter section must be cleaned at least once per month.
- Use a dishwashing brush to clean the coarse and fine filter. Put the filter section back together again according to the illustration opposite and then re-fit the whole filter section back into the tub of the dishwasher.

Never use the dishwasher without the filter section. Incorrect fitting of the filter section will result in the dishwasher no longer delivering maximum performance. Damage to cutlery and dishes is a further possible consequence.

Cleaning the spray arms

It is essential that you clean the spray arms on a regular basis. In the longer term, waste can block the nozzles and the bearings in the spray arms. Clean the spray arms as follows:

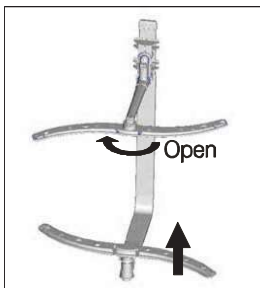

- To remove the upper sprayarm, hold the nut , rotate the arm clockwise to remove it. To remove the lower spray arm, pull out the spray arm upward.
- Clean the spray arms in warm, soapy water, using a soft brush to clean the nozzles.
- Rinse the spray arms thoroughly before fixing back in place.

Cleaning the door

Clean the edge of the door, including the sealing rubber, with a soft, damp cloth. Take care to ensure that water does not enter the door locking mechanism or electrical components. Spray-type cleaning products should not be used, nor aggressive cleaning products such as scourers. These cleaning products can damage the finish.

ERRORS

What should I do, if...

If the appliance is not functioning well, this does not always mean that it is faulty. Try to resolve the fault yourself first. If the recommendations below does not solve your problem, telephone our service department.



Note!

Disconnect the appliance from the power supply before beginning repairs. It is preferable if you remove the plug from the socket.

Error table

Problem	Potential causes	Solution
The dishwasher is not working.	Fuse is faulty or the earthing switch has been activated.	Replace the fuse or reset the isolating switch. Remove other appliances that are connected to the same group.
	The power supply is not switched on	Make sure that the dishwasher is switched on and the door closed. Make sure that the plug is correctly inserted into the socket.
	The water pressure is too low.	Check whether the dishwasher is correctly connected to the water mains and that the tap is open.
The drainage pump does not shut off.	The water is running over.	The system is designed so that it can automatically detect overflowing water. In that instance, the appliance shuts off the circulation pump and switches on the drainage pump.
Noise.	Some noises are normal.	Noise of rotating pump/washing noises; the detergent compartment opening.
	Cutlery is rattling in cutlery basket or something small has fallen out of the basket.	Ensure that everything is loaded securely in the dishwasher.
	The motor makes an unusual noise.	The pump is blocked. Contact an installer.
Contamination of the tub.	Poor quality detergent.	Only use detergent suitable for dishwashers to prevent contamination.
	Blocked filters	Open the door and clean the filters. Run the pre-wash cycle.
	Rinse agent has been spilled.	Always wipe up spilled rinse agent immediately.

ERRORS

Problem	Potential causes	Solution
Dishes not dry.	The rinse agent reservoir is empty.	Ensure that the rinse agent reservoir is filled.
Dishes and flat objects are not clean.	Incorrect cycle.	Select a higher cycle.
	Baskets are incorrectly loaded.	Make sure that the detergent compartment and spray arms are not obstructed by large dishes/pans.
Spotting and scaling on glasses and flat dishes.	Extremely hard water. Incoming water temperature is low. The dishwasher is overloaded. Baskets are incorrectly loaded. Old or damp detergent. Rinse agent reservoir is empty. Incorrect detergent dosage.	To remove spotting from glass objects: Remove all metal objects from the dishwasher. Use the prescribed quantity of detergent. Select the longest cycle. Allow the dishwasher to run for approximately 18 to 22 minutes. It should by then have reached the main wash cycle. Open the door carefully and pour 2 cups of white vinegar into the base. Close the door and allow the dishwasher to complete its cycle. If vinegar does not work: Repeat the above steps, but use a quarter cup (60 ml) of citric acid crystals in place of white vinegar.
Cloudy stains on the glassware.	Combination of soft water and too much detergent.	Use less detergent and choose the glass cycle, which you can use to clean glassware.
Yellow or brown scale on the inside of the tub.	Traces of iron in the water may cause spotting to the tub of the dishwasher.	Contact a manufacturer of water softeners for a special filter.
White scale on the inside of the tub.	Hard water.	Increase salt consumption setting
Dishwasher detergent is left in the detergent compartment.	The detergent compartment is blocked by dishes.	Load the baskets so that the dishes no longer block the detergent compartment. Clean the upper spray arm.
Steam.	When opening the door.	This is possible at the end of the cycle.
Black or grey stains on the dishes.	Aluminium cooking utensils have scraped the dishes.	Aluminium can tarnish.
Water remains under the filters.	This is normal.	A small amount of water around the drain on the rear of the tub base keeps the seal flexible.
The dishwasher is leaking.	Rinse agent reservoir too full or rinse agent is leaking.	Take care not to overfill the rinse agent reservoir. Spilled rinse agent can lead to foam/flooding. Wipe up spilled rinse agent with a damp cloth.
	The dishwasher is not standing level.	Adjust the dishwasher so that it is standing level.

ERRORS

Error codes

Problem	Potential causes	Solution
Code E1 is showing in the display	Water intake time is too long.	Faucets is not opened, or water intake is restricted, or water pressure is too low.
Code E4 is showing in the display	Overflow.	Some element of dishwasher leaks. Note the code and alert the service department.



Should the appliance become overfilled or exhibit excessive leaking, shut off the inlet tap and alert the service department. If all indicators are flashing simultaneously: switch off the dishwasher immediately, shut off the inlet tap and alert the service department.

TECHNICAL DATA SHEET

Built-in dimensions

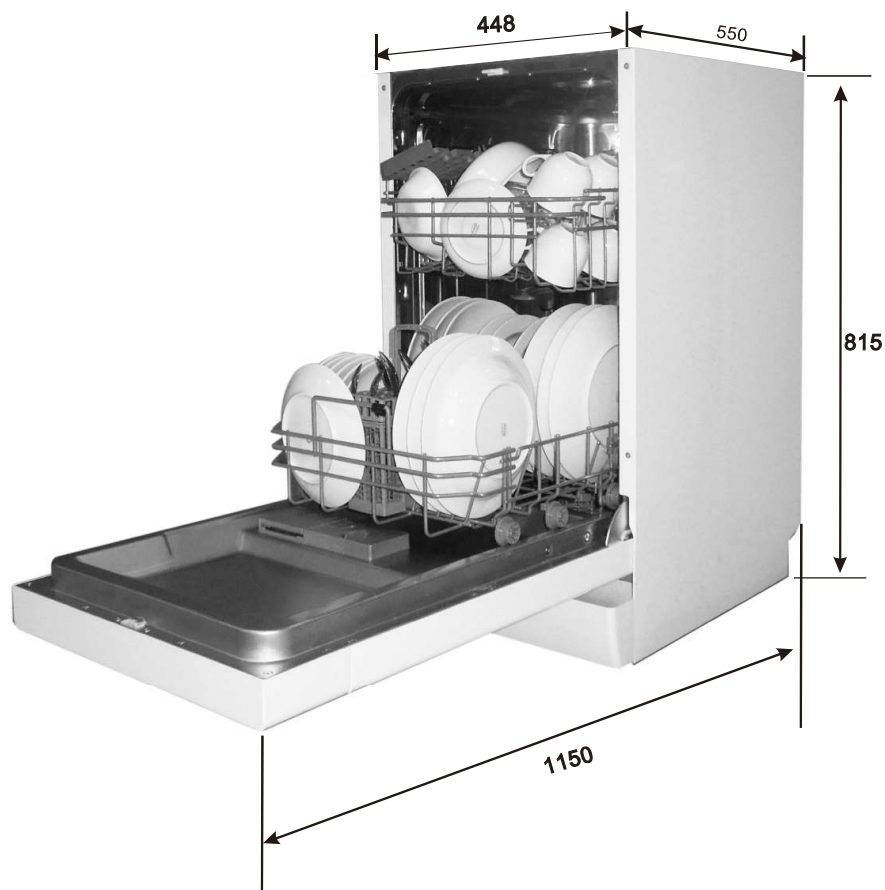

Technical data sheet

Sheet of household dishwasher according to EU Directive 1059/2010:

Manufacturer	Etna
Type / Description	VW147SRVS
Standard place settings	9
Energy efficiency energy efficiency class (1)	A++
Annual energy consumption (2)	197 KWh
Cleaning efficiency class	A
Drying efficiency class (4)	A
Energy consumption of the standard cleaning cycle	0.69 KWh
Standard cleaning cycle	ECO 45 °C
Program duration of the standard cleaning cycle (5)	190 Min.
Power consumption of off-mode	0.45 W
Power consumption of standby-mode	0.49 W

TECHNICAL DATA SHEET

Annual water consumption (3)	2520 L
Noise level	47 dB(A) re 1pW
Mounting	Build-in
Height	81.5 cm
Width	44,8 cm
Depth (with connectors)	55 cm
Power consumption	1760-2100 W
Rated voltage / frequency	220-240 V~ 50 Hz
Water pressure (flow pressure)	0.4-10 bar = 0.04-1 Mpa

1. A + + + (highest efficiency) to D (lowest efficiency)
2. on the basis of 280 standard cleaning cycles. Actual annual energy consumption depends on the actual frequency of usage.
3. on the basis of 280 standard cleaning cycles. Actual annual water consumption depends on the actual frequency of usage.
4. A (highest efficiency) to G (lowest efficiency)
5. This program is suitable for cleaning soiled normally soiled tableware and that it is the most efficient programme in terms of its combined energy and water consumption for that type of tableware.

The device meets the European standards and the directives in the current version at delivery:

- LVD 2004/95/EC
- EMC 204/108/EC
- EUP 2009/125/EC

Note: The above values have been measured in accordance with standards under specified operating conditions. Results may vary greatly according to quantity and pollution of the dishes, water hardness, amount of detergent, etc.

The manual is based on the European Union's standards and rules.

LOADING THE BASKETS ACCORDING TO EN50242

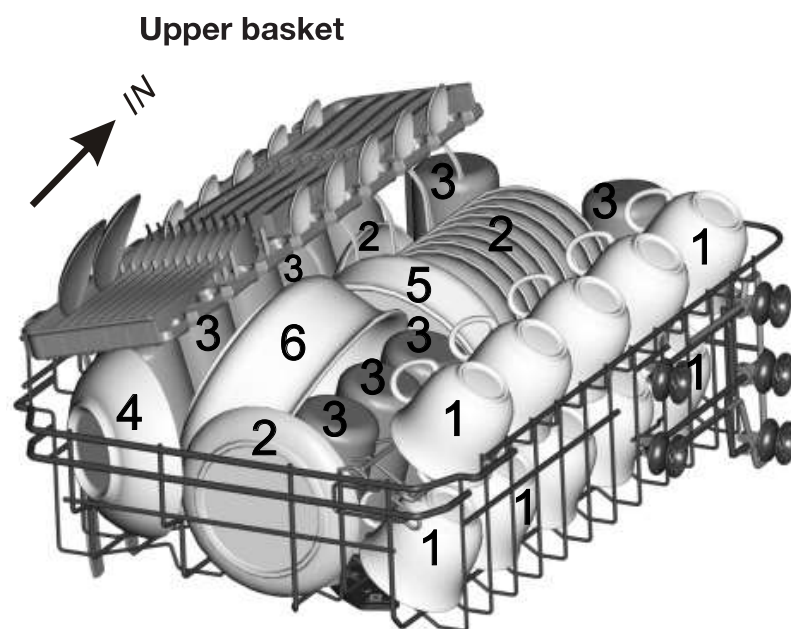

Lower basket

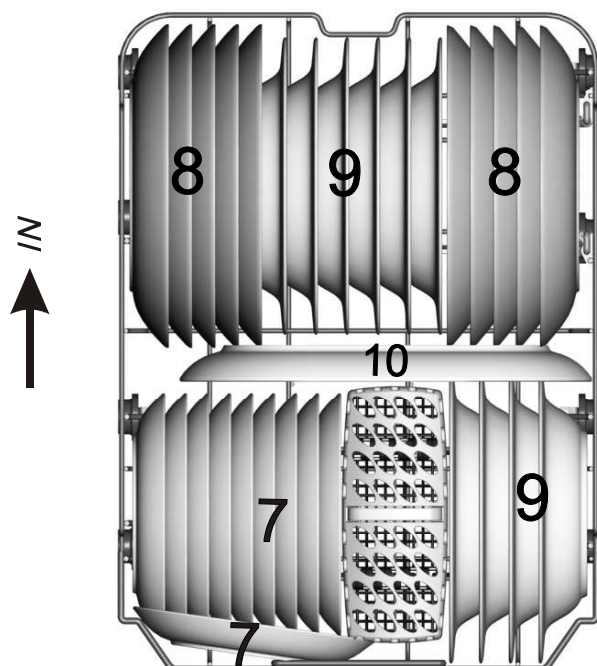

LOADING THE BASKETS ACCORDING TO EN50242

Cutlery basket

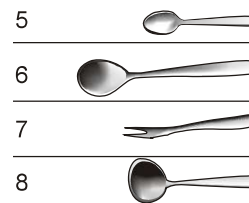
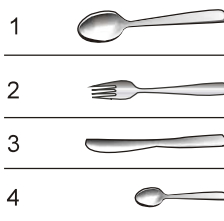
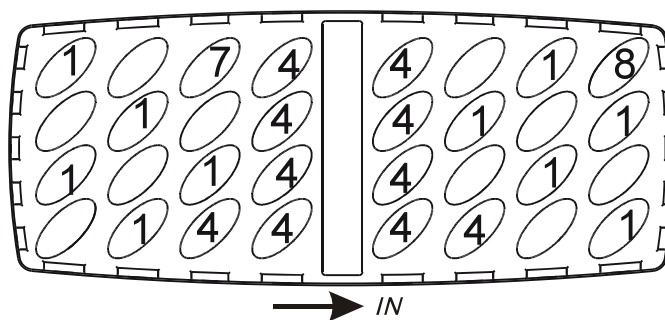
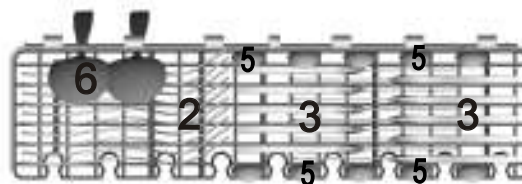

EN 50242: This is a test cycle. The information for a comparison test in accordance with EN 50242 is as follows:

- Capacity: 9 place settings
- Position of upper basket: upper wheels on runners
- Program: ECO
- Wash setting: 6
- Softener setting: H3

Disposal

Disposing of the packaging and appliance

Sustainable materials were used in the manufacture of this appliance. At the end of its life cycle, this appliance should be disposed of in a responsible manner. The government can provide you with information in this regard.

The packaging for the appliance is recyclable. The following may be used:

- cardboard;
- polyethylene film (PE);
- CFC-free polystyrene (PS hard foam).

The materials should be disposed of in a responsible manner and in accordance with government regulations.



The product bears the symbol of a crossed out waste bin to draw attention to the obligation regarding separate processing of electrical household appliances. This means that the appliance cannot be added to your normal household waste at the end of its lifecycle. The appliance must be taken to a special municipal waste collection centre, or to a sales outlet that offers this service.

Separate processing of household appliances prevents the potentially negative consequences for the environment and health that can arise as a result of inadequate processing. It ensures that the materials which the appliance is composed of can be reclaimed, allowing for considerable savings to be made in terms of energy and materials.



Note! The packaging material may be hazardous for children.



Declaration of conformity

We hereby declare that our products satisfy the applicable European directives, orders and regulations



602842

602842 / VER 1 / 14-11-2016

ETNA maakt **kwaliteit** betaalbaar

